

-A-

**ISTRUZIONI PER IL MONTAGGIO DELLA PILETTA DI SCARICO CON SPESSORE
SUL TOP IN VETRO**

INSTRUCTION FOR THE FITTING OF THE BASIN WASTE TO THE GLASS TOP WITH WASTE SPACER

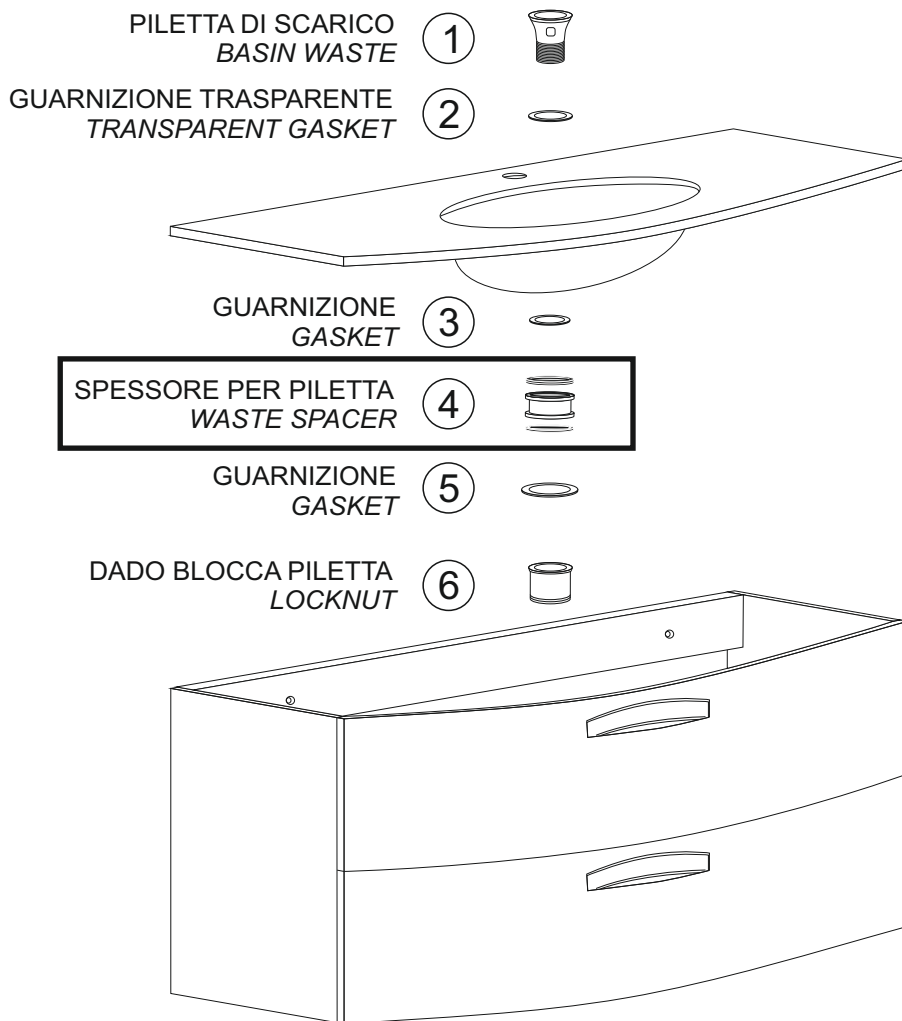

IL COLLEGAMENTO DEL TUBO DI SCARICO DEL LAVABO DEVE ESSERE FATTO DA UN IDRAULICO O DA UNA PERSONA SPECIALIZZATA
THE CONNECTION OF THE DRAIN LINE MUST BE DONE BY A HYDRAULIC OR BY A QUALIFIED PERSON

IL DADO PORTA PILETTA ⑥ DEVE ESSERE MONTATO CORRETTAMENTE E NON ESSERE SERRATO TROPPO ALTRIMENTI SI ROMPE IL TOP IN VETRO
THE LOCKNUT ⑥ MUST BE MOUNTED PROPERLY AND NOT LOCKED TOO MUCH, OTHERWISE THE GLASS TOP WILL BREAK

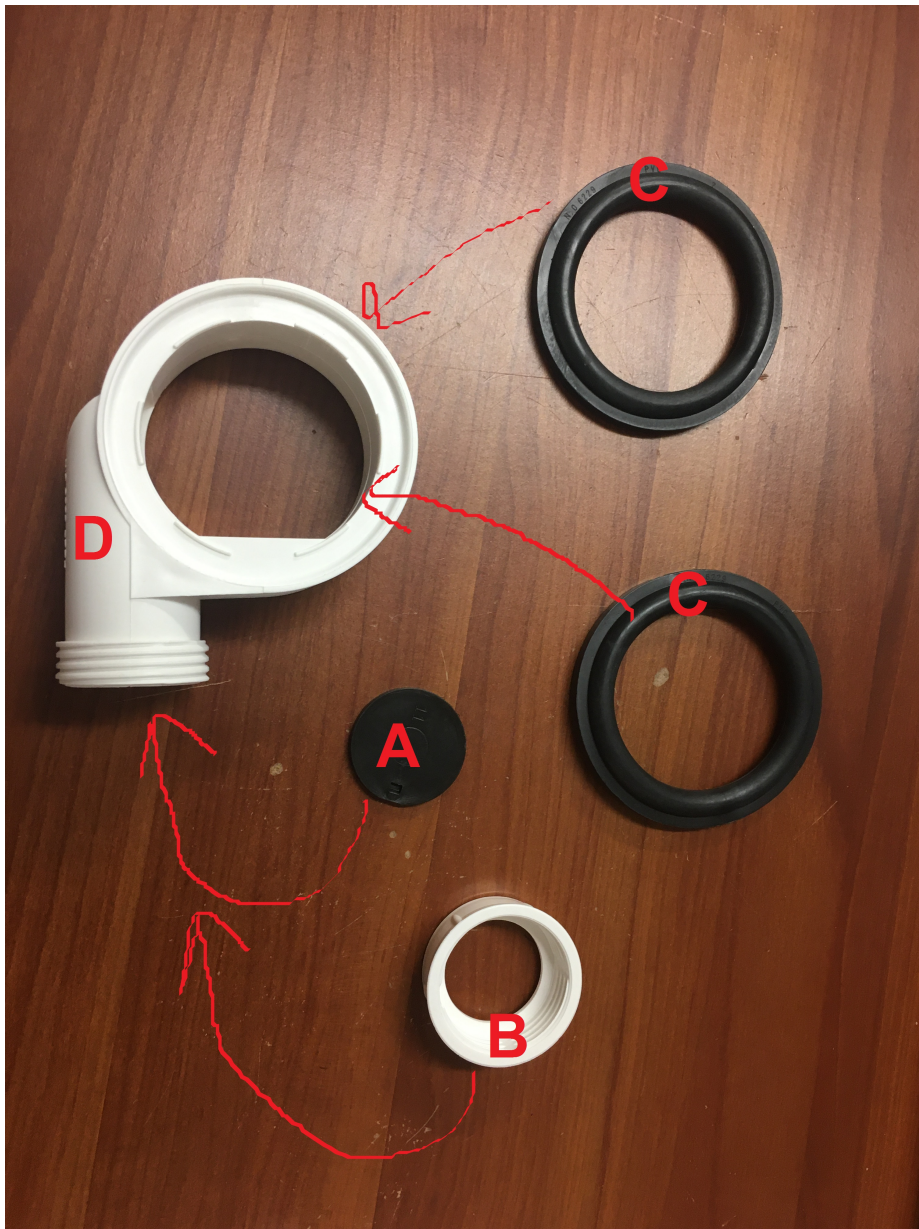

A: Plug to go into overflow portion of D

B: Plastic Ceil tight adaptor to go over A, ceiling D shut from overflow side

C: identical Pcs, one goes on top of D and the other on the bottom